



# STRUDCO SERVICES LLP

AN ISO 9001:2015 CERTIFIED



# ABOUT OUR COMPANY

[www.strudco.com](http://www.strudco.com)

We have a team of engineers having absolute passion about modelling, analysis & design of steel & stainless steel, RCC, façade, and Aluminium and glass structures. We also have highly experienced detailers for BIM, Structural, Façade, and MEP. We take pride in providing our customers the best service which is cost effective and focused on quality and speed. The company operates from its head office at Kollam, Kerala India. Our engineering team has profound national and international experience in a wide array of fields and utilizes most modern technologies and original software's that helps to reduce design time without compromising in quality of the deliverables. We are well versed with all major international standards and codes. We have completed many projects over the globe. Today's construction projects have fast-tracked schedules that are neck-to-neck with design, and we are always ready for this challenge. We welcome complex and challenging jobs. Our list of completed and successful projects are proof that we can make it happen. We strive to mobilize the best resources we have worldwide to satisfy our clients' needs anywhere in the world.





# VISION & MISSION

[www.strudco.com](http://www.strudco.com)

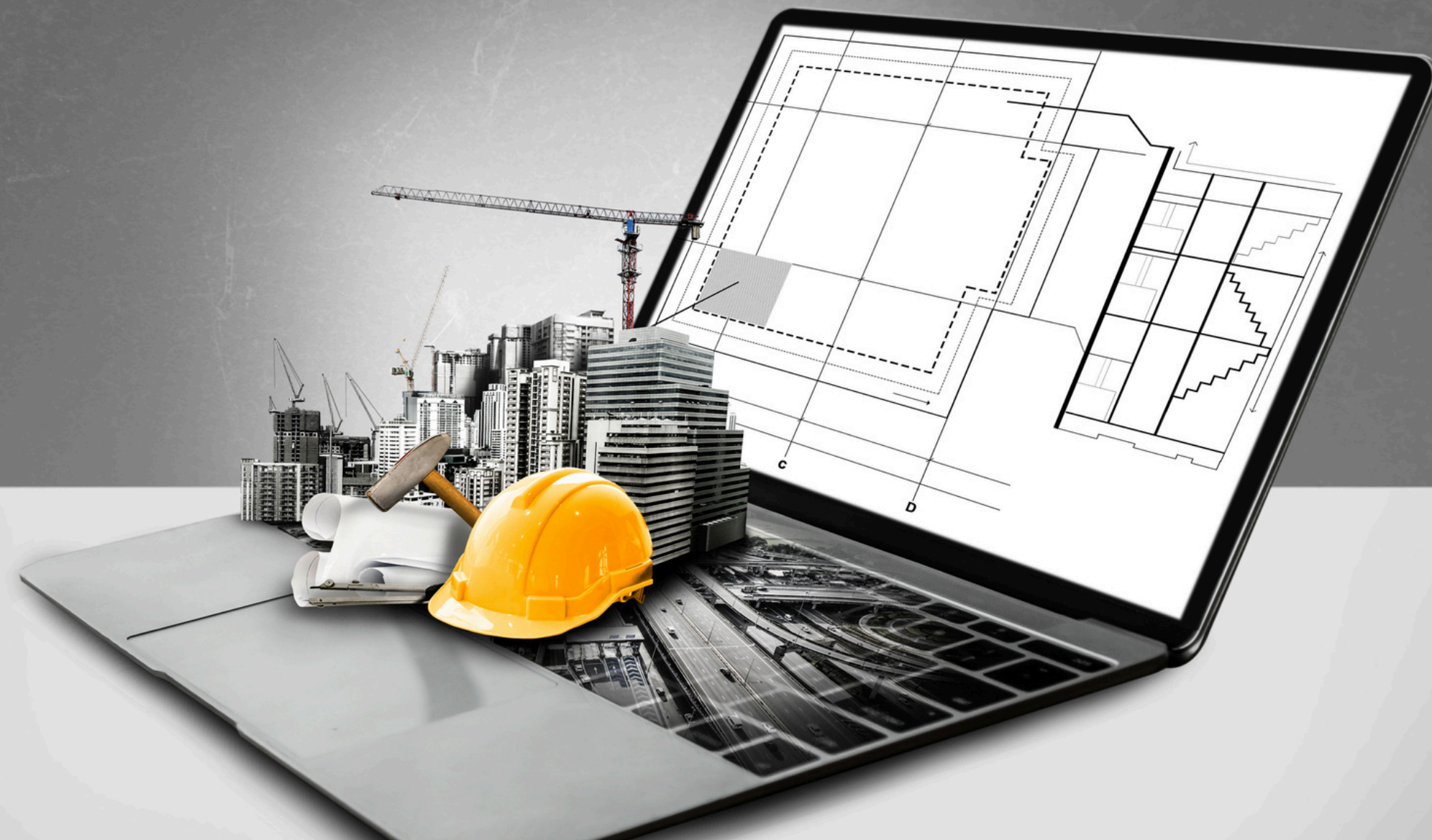

## Vision

To be a global technology leader, delivering innovative, efficient and reliable solutions for a better world.

## Mission

To deliver products and services with a strong commitment on fairness, honesty and respect towards our clients, vendors, stakeholders, society and environment.

# OUR SERVICES

[www.strudco.com](http://www.strudco.com)

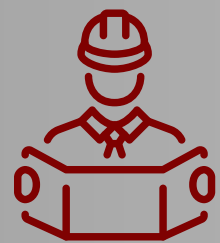

## ENGINEERING SERVICES

- Structural Services
- Design and analysis
- Connection design
- Design drawings

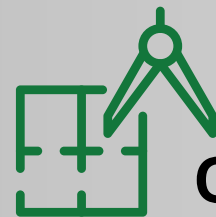

## CAD SERVICES

- Shop drawings
- As-Built drawings
- Steel detailing
- Rebar detailing
- Infrastructure drafting
- Structural drafting



## BIM Services- Architectural Structural and MEP (LOD100-500)

- BIM
- BIM Coordination
- BIM Consulting
- Scan to BIM
- Fabrication drawing
- Erection Drawings
- As Built drawings



# OUR MAJOR PROJECTS



**THE ROYAL ATLANTIS RESORT AND RESIDENCES  
PALM JUMEIRAH CRESCENT , DUBAI U.A.E**



**REHABILITATION AND UPGRADING OF IRBID  
CENTRAL AND WADI ARAB WWTPS , JORDAN**



**Corinthia Gewan Villas and Promenade ,QATAR**



**THE PEARL INTERNATIONAL Hospital QATAR**



# OUR MAJOR PROJECTS



LUSAIL PLAZA TOWER, QATAR



THE VIEW HOSPITAL, QATAR



DUNKIN, QATAR



WOW CINEMAS, SALALAH GRAND MALL, OMAN



# OUR MAJOR PROJECTS



**BACS RIYADH METRO PROJECT, RIYADH , KSA**



**CITY UNIVERSITY COLLEGE, AL ERKYAH , LUSAIL**



**COLLEGE OF MEDICINE AND HEALTH SCIENCES ,  
QATAR**



**KATARA TWIN TOWER Hotel, QATAR**





# OUR MAJOR PROJECTS

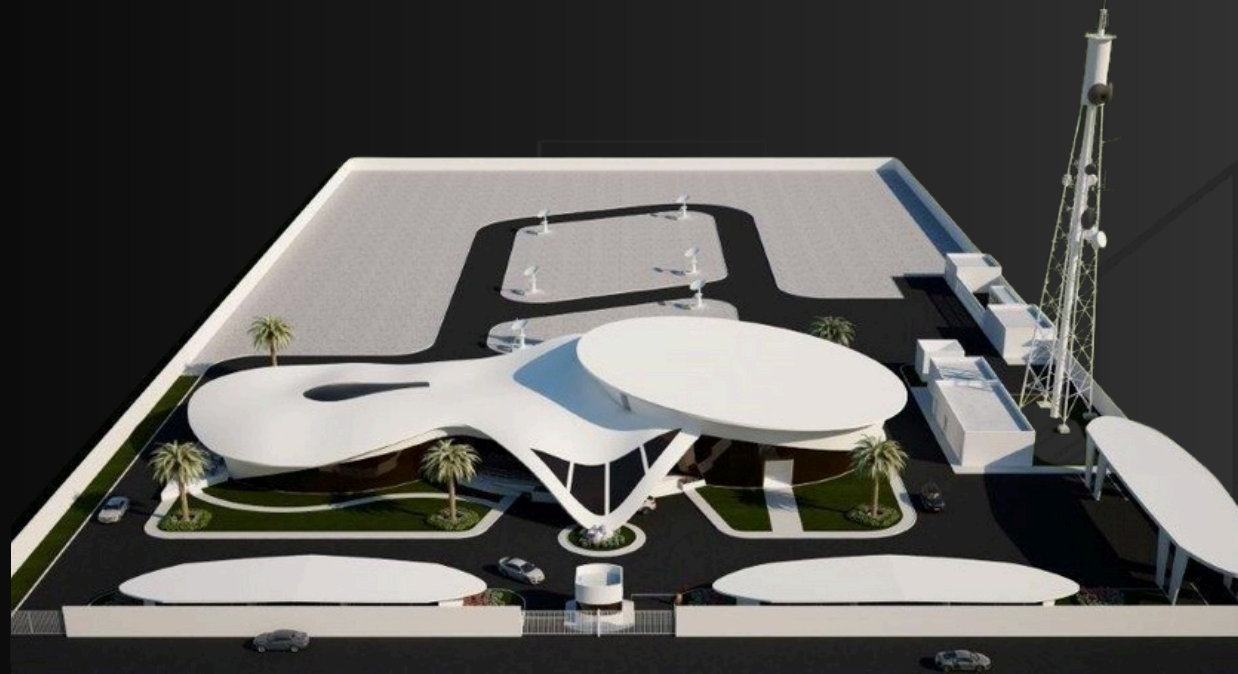

**Communications Regulatory Authority - Satellite Monitoring Center, Al Markhiya West, Qatar**



**QIDDIYA SIX FLAGS, KSA**



**BAHIRIN MARINA**



**LUSAIL SURGI-ART CENTER**





## OUR PROJECT LOCATIONS



- QATAR
- UAE
- SAUDI ARABIA
- JORDAN
- OMAN
- IRELAND
- KENYA
- CANADA
- SINGAPORE
- AUSTRALIA
- USA



 **CLIENTS**





 **CLIENTS**

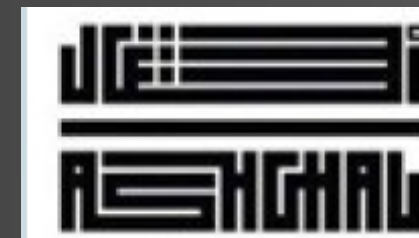



# KEY PERSONNEL



## **BAIJU T BABY**

**CHIEF EXECUTIVE OFFICER & FOUNDER**

**MOB: +974 5557 9801, +91 8593053989**

As the CEO of Strudco Services LLP, it gives me immense pleasure to present our company's portfolio. Strudco Services LLP stands at the forefront of engineering consultancy, dedicated to delivering innovative solutions that drive success for our clients. Our journey has been one of commitment, growth, and excellence, and I am proud to share our story with you. Our approach is client-focused and results-driven. We start by understanding the unique needs and challenges of each project. Our team of seasoned engineers and consultants then crafts bespoke solutions, leveraging state-of-the-art technology and best practices in the industry.

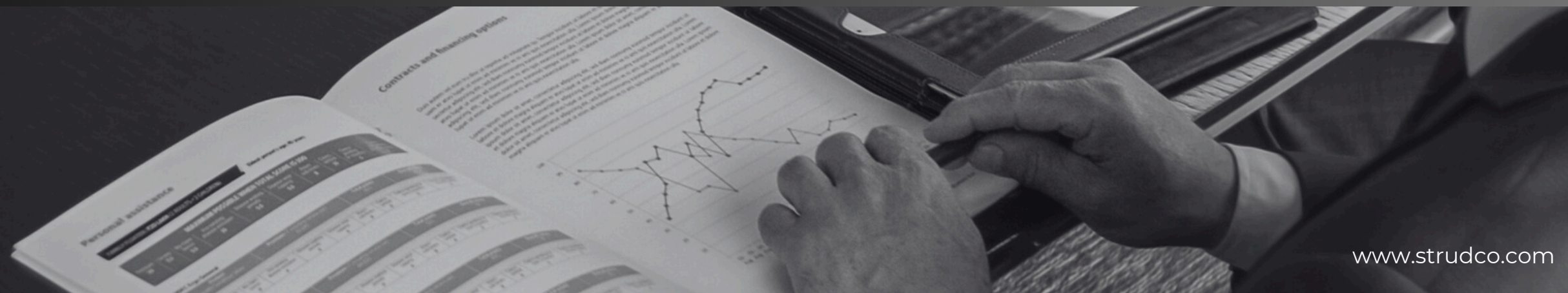



# CONTACT US

We treat every structure as a problem to be solved. Not taking the existing as the limiting factor, our constant endeavor is to go beyond the obvious.



## Address

PUNALUR, KERALA, INDIA. 691305



## PHONE

Telephone :+91475 2964629

+914752224629

Mob: +97455579801/+918593053989



## EMAIL

info@strudco.com

sales@strudco.com



## WEBSITE

www.strudco.com

